

NOTES

1. EQUIPMENT LOCATIONS ARE INDICATIVE ONLY, REFER TO THE SPECIFICATION AND ARCHITECTURAL DRAWINGS IN CONNECTION WITH THIS DRAWING TO DETERMINE FINAL LOCATIONS. FINAL LOCATIONS MAY BE SUBJECT TO APPROVAL PRIOR TO INSTALLATION.
 2. MOUNT PA ABON SPEAKERS ON WALL HIGH LEVEL IN PROTECTIVE CAGES.
 3. CR'S AND 1'S FOR MESH GATES SHALL BE CENTRALLY LOCATED AND SHARED WITH BOTH SIDES OF THE GATE.
 4. NOT USED
 5. INTERCOM MASTER STATION (CONSOLE TYPE) FOR LOCAL PA USE.
 6. MONITOR AND CCTV MONITORBOARD TO ALLOW MONITORING OF EA.
 7. LOCATION BEACONS SHOWN ON SEPARATE DWG.
 8. SPACE PROVIDED FOR SECURITY AND COMMS RACKS AND PANELS. PROVIDE SECURITY RACK AND/OR PANEL AS NECESSARY. THIS ROOM HAS A COMMS RACK IN IT. DESCRIBED IN THE COMMS SPECIFICATION AND SHOWN ON DWG XS1501. 25RU OF THIS RACK IS AVAILABLE FOR SECURITY EQUIPMENT. COORDINATE POSITION AND ACCESS TO RACK WITH COMMUNICATIONS INSTALLER. RACK AND PANEL SYMBOLS NOT TO SCALE.
 9. CONDUIT ACCESS SHOWN ON DWG XS1501.
 10. REFER TO DOOR SCHEDULE FOR ELECTRIC LOCK DETAILS.
11. POSITION DOOR P1ZS UNDER WALKWAY DOOR SUCH THAT THEY CAN BE ACCESSED VIA SCAFFOLD OR SCISSOR LIFT ON THE WALKWAY.

REFER XS1602 FOR CONTINUATION

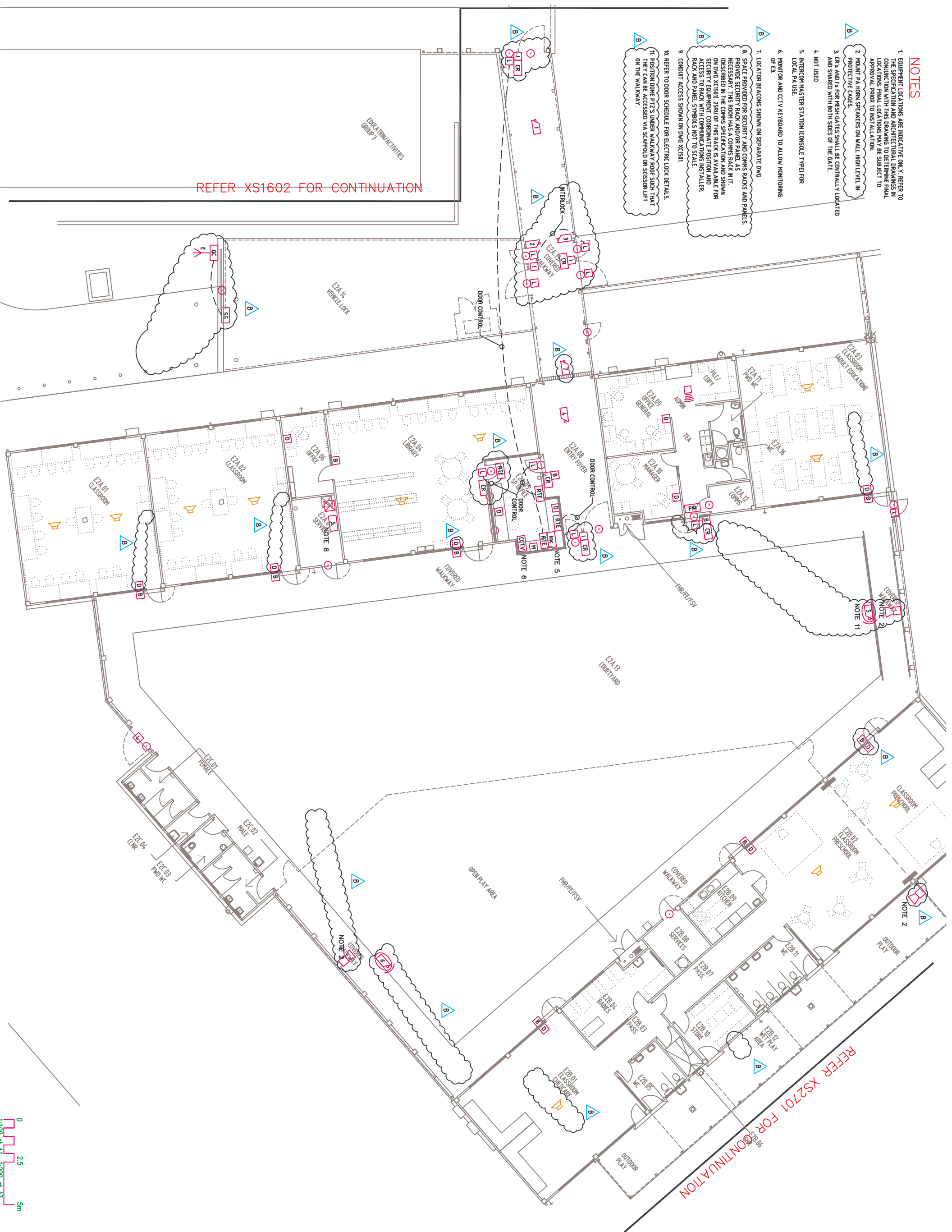

NO	SUBJECT	INT	DATE
C01	FIRST INTERIM ISSUE	H/W	14.08.24
C02	SECOND INTERIM ISSUE	H/W	15.08.24
C03	THIRD INTERIM ISSUE	H/W	24.08.24
C04	REVISION		
C04	SECOND INTERIM ISSUE	H/W	13.09.24
C05	PRELIMINARY ISSUE 3	H/W	05.10.24
C05	2 ELECTRIC LOCK ADD'D		
C05	3 MAGNETIC LOCK		
C05	1 MAGNETIC LOCK		
C06	ISSUE 3	H/W	08.10.24
C06	ISSUE 3	H/W	08.10.24
C06	1 ELECTRIC LOCK, 2 RTE		
C06	3 REED SWITCH, 1 RM		
C06	2 ELECTRIC LOCK REMOVED		
C06	1 CARD READER RELocATED		
C06	1 MAGNETIC LOCK CHANGED		
C07	FINAL INTERIM ISSUE	H/W	05.11.24
C07	NOTE 2 & 4 REVISION		
A	NO AMENDMENTS	H/W	18.12.24
B	COORDINATION ISSUE	H/W	23.02.25
B	NO AMENDMENTS		
B	3 ADDITIONAL ROOMS		
B	2 ADDITIONAL ROOMS		
B	CAMERAS 5 & 6 RELocATED		
B	2 X HORN RELocATED IN		
B	COMPTON AND E2A.08 TO		
B	CONTRACTOR		
B	RED SWITCH, ELECTRIC		
B	LOCK & INTERCOM		
B	CAMERA 2 & 3 RELocATED		
B	E2A.11, REED SWITCH 1		
B	6C RELocATED, REMOVED		
B	PA HORN, NOTE 7 & 8		
B	PA HORN, NOTE 7 & 8		
B	PA HORN, NOTE 7 & 8		
C	CONSTRUCTION ISSUE	H/W	02.03.25
C	NO AMENDMENTS		

ARCHITECT: Phillips Smith Connell Architects
 CAD: GHD
 SYMBIOTIC: Cedric Alexander Browne
 STRUCTURE: Cedric Alexander Browne
 ELECTRICAL: NOT
 FIRE ENGINEER: NOT
 MECHANICAL: Heston Akinola-Rose
 CIVIL/SLURRY: Mads Antonio Group
 ACQUISITION: Hyder Associates P/L
 FOOD & BEV: Food Service Design
 LANDSCAPE: Gormon Nicholson

PHILLIPS SMITH CONNELL ARCHITECTS
 for
 CHRISTMAS ISLAND
 IRPC
 DEPARTMENT OF
 FINANCE AND ADMINISTRATION

ARCHITECTS
 A.C.N. 009 866 882
 PVT LTD
 60 BERNICK STREET PO BOX 478
 FORTITUDE VALLEY QLD 4006
 PH: 07 3251187 FAX: 07 3251197

EDUCATION/ACTIVITIES GROUP 2
 SECURITY SERVICES
 BLOCK E2

SCALE
 1:100 at A1
 1:200 at A3
 PROJECT: 4881
 DRAWING NO: XS1501
 SHEET: C